



**CARTER**REMY  
ESTATES



# Wood Green, Basildon, SS13

Guide Price £345,000

3 1 1





Guide price £345,000-£365,000. Welcome to this delightful three-bedroom semi-detached home, perfectly situated on a generous corner plot in a peaceful cul-de-sac location. This property boasts a single detached garage along with parking space for two additional cars, making it ideal for families or those needing extra space.

As you enter, you'll be greeted by a bright and inviting interior, featuring a lovely conservatory that opens to the rear, perfect for enjoying the garden throughout the seasons. The home offers ample potential for extension, allowing you to tailor the space to meet your needs.

Located close to a local primary school, this residence is perfect for families with children. The Burnt Mills area is renowned for its beautiful woodland walks, providing wonderful opportunities for dog walking and enjoying the great outdoors.

Additionally, you'll find yourself just a short distance from Mayflower, where you can explore a variety of shops and restaurants, ensuring all your shopping and dining needs are met.

This property presents a fantastic opportunity for a comfortable family home in a desirable location. Don't miss your chance to make it yours!



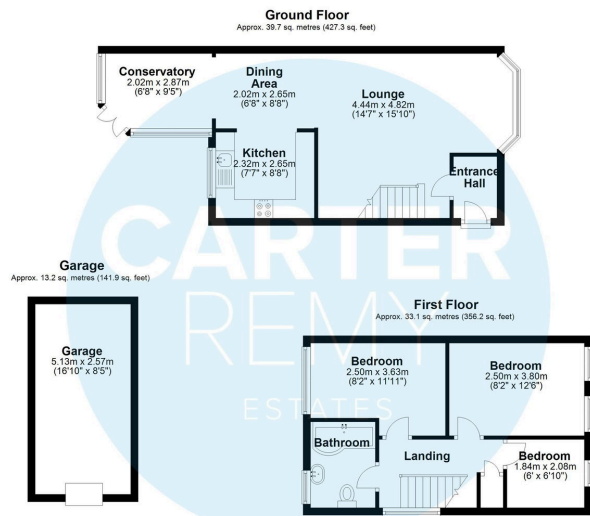

Total area: approx. 86.0 sq. metres (925.4 sq. feet)

All measurements have been taken as a guide to prospective buyers only and are not precise. This plan is for illustrative purposes only and no responsibility for any error, omission or misstatement. The services, systems and appliances shown have not been tested and no guarantee as to their operability or efficiency can be given. Measurements may have been taken from the widest area and may include wardrobe/closetboard space. No guarantee is given to any measurements including total areas. Buyers are advised to take their own measurements.

Plan produced using PlanIt.  
Wood Green, Basildon

- 3-bedroom semi-detached home
- Peaceful cul-de-sac setting
- Bright conservatory to the rear
- Close to local primary school
- Short distance to Mayflower for shops and restaurants
- Located on a generous corner plot
- Single garage plus parking for 2 additional cars
- Potential for extension to customize living space
- Access to Burnt Mills area with beautiful woodland walks
- Ideal for families and outdoor enthusiasts



Energy Efficiency Rating		
	Current	Potential
Very energy efficient - lower running costs		
(92 plus) <b>A</b>		
(81-91) <b>B</b>		86
(69-80) <b>C</b>	73	
(55-68) <b>D</b>		
(39-54) <b>E</b>		
(21-38) <b>F</b>		
(1-20) <b>G</b>		
Not energy efficient - higher running costs		
<b>England &amp; Wales</b>	EU Directive 2002/91/EC	



Where **dreams** come home

Cornwallis business centre,  
Howard chase, Basildon,  
Essex, SS14 3BB

T 01268 727757  
E info@carterremy.co.uk  
W www.carterremy.co.uk